

SPECIFICATION	VALUE
NO. OF PHASE	2
AMPS/PHASE	0.5
RESISTANCE/PHASE(Ohms)@25°C	6±7%
INDUCTANCE/PHASE(mH)@1KHz	1.4±20%
HOLDING TORQUE(mN.m)[lb-in]@25°C	53.9[0.48]
GEAR RATIO	50
STEP ANGLE W/O GEARBOX(°)	18±7%
MAX. PULL-IN RATE(PPS)@25°C 0.5A	1100
PULL-IN TORQUE(m.Nm)@350PPS 25°C 0.5A	53.9
WEIGHT(g)[lb]	14.2[0.03]
INSULATION RESISTANCE(MΩ) @DC 500V	100
TEMPERATURE RISE:MAX.65°C	
AMBIENT TEMPERATURE -10°C~40°C[14°F~104°F]	
INSULATION CLASS E 120°C[248°F]	
DIELECTRIC STRENGTH 650VAC FOR 1SEC.(BETWEEN THE MOTOR COILS AND THE MOTOR CASE)	

FULL STEP 2 PHASE-Ex. ,
WHEN FACING MOUNTING END (X)

PIN NO.	WIRE COLOR	STEP			
		1	2	3	4
1	ORG	-			-
2	YEL		-	-	
3	BLK	-	-		
4	BRN			-	-

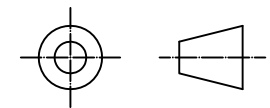
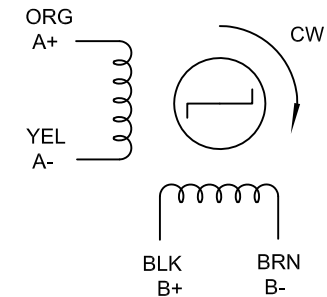

mm	APVD	5.16.2019
UNIT	CHKD	
2:1	DRN	
SCALE	SIGNATURE	DATE

PM STEPPER MOTOR

15PM20L01-SG50